

# Welcome!

We'll start at 10:02-*ish*

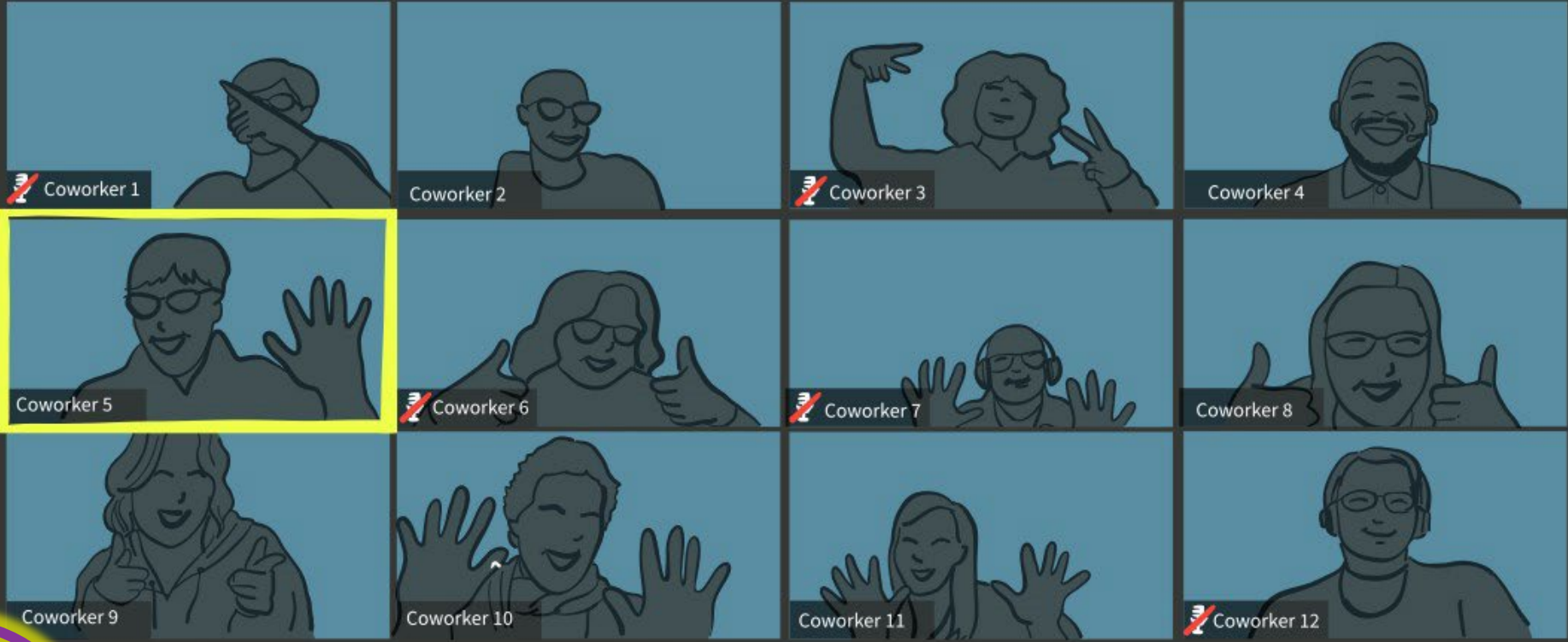

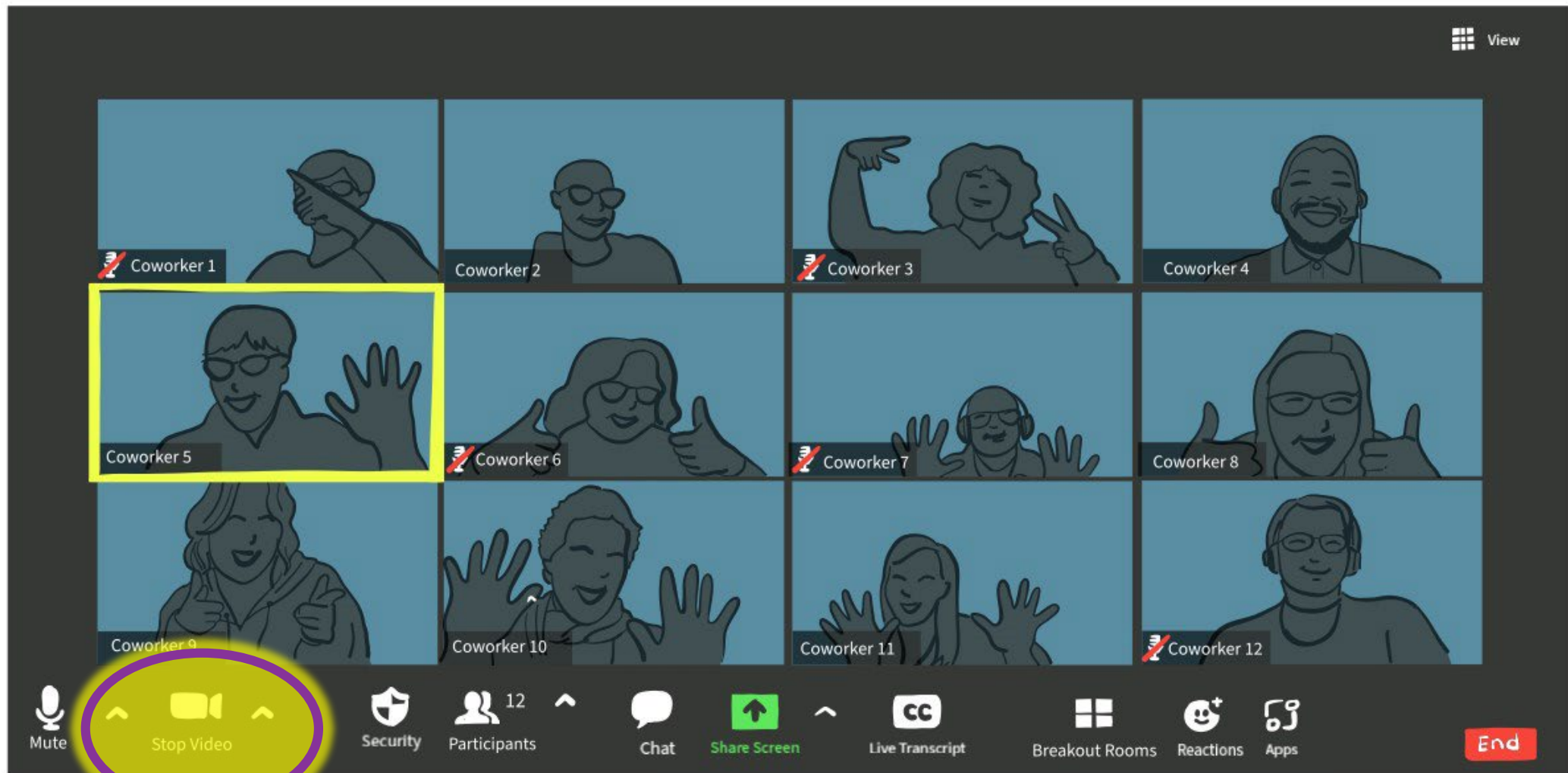



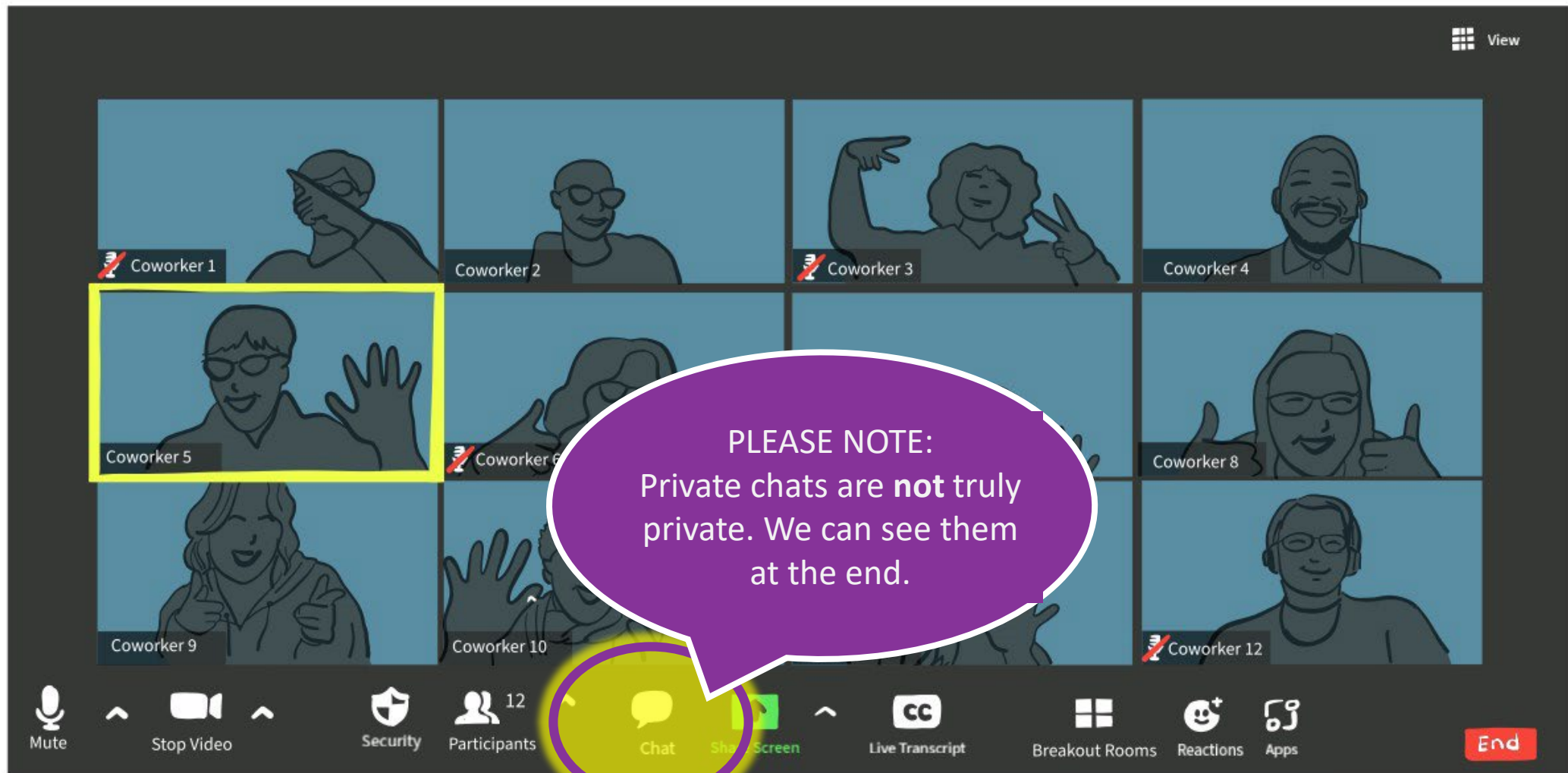



Choose ONE of the audio conference options

Phone Call Computer Audio

Already joined by phone? Enter #44# on your phone.

Dial: +1 669 900 6833  
+1 929 205 6099

Meeting ID: 171 331 446

Participant ID: 44

Done

1360\*\*\*\*462

worker 2

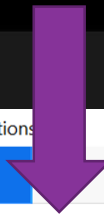
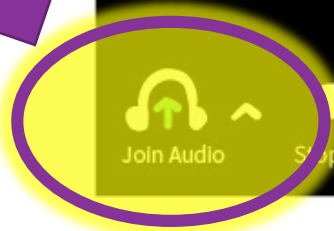

End

# Overview

## **During this webinar, we will:**

- Explore the ESIT.Web platform
- Show users the school district reports available
- Gather feedback and answer questions



## May we Introduce?

- The ESIT.Web application was released prior to the funding shift from OSPI to DCYF
- The ESIT.Web application features the school district portal among other enhancements
- We do not currently have plans to replace the ESIT.Web application and the school district portal when we shift to a new data management system.



# ESIT.Web School District Portal

Log in to the ESIT DMS

<https://apps.dcyf.wa.gov/ESIT.Web>

Username and Password have not changed.

Please contact the Help Desk if you need login credentials.

[Early Learning Portal](#) » Home

## My Applications

You have access to the applications listed below. Click on the application you would like to use.

| Application                                     | Roles    | Contact  |
|---|----------|--|
| <a href="#">MERIT</a>                           |          | <a href="mailto:merit@del.wa.gov">merit@del.wa.gov</a>         |
| <a href="#">Early Learning Portal</a>           |          |  |
| <a href="#">ESIT</a> <a href="#">Click here</a> | ESIT Web | <a href="mailto:esit.help@del.wa.gov">esit.help@del.wa.gov</a> |
| <a href="#">ELMS</a>                            |          | <a href="mailto:elms@del.wa.gov">elms@del.wa.gov</a>           |
| <a href="#">BackgroundCheckPortal</a>           |          |  |

**News & Information:**  
[More News & Information](#)



# ESIT.Web School District Portal



- All School District staff are listed as “Special Education Contact” and have access to the ESIT.Web portal
- School Reports are visible to all users (bottom left corner of the screen)
- IFSPs are only accessible if parental consent is on file and the FRC has requested this access level through the Help Desk

# Children in the School District Portal

Children visible in the School District Portal must be:

- At least 2 yrs 3 months old
- Have an initial IFSP in place
- The Child is potentially eligible for Part B services (checkbox in DMS is selected)

The most recent IFSP is accessible to the school district liaison if the FRC has requested access through the ESIT Help Desk

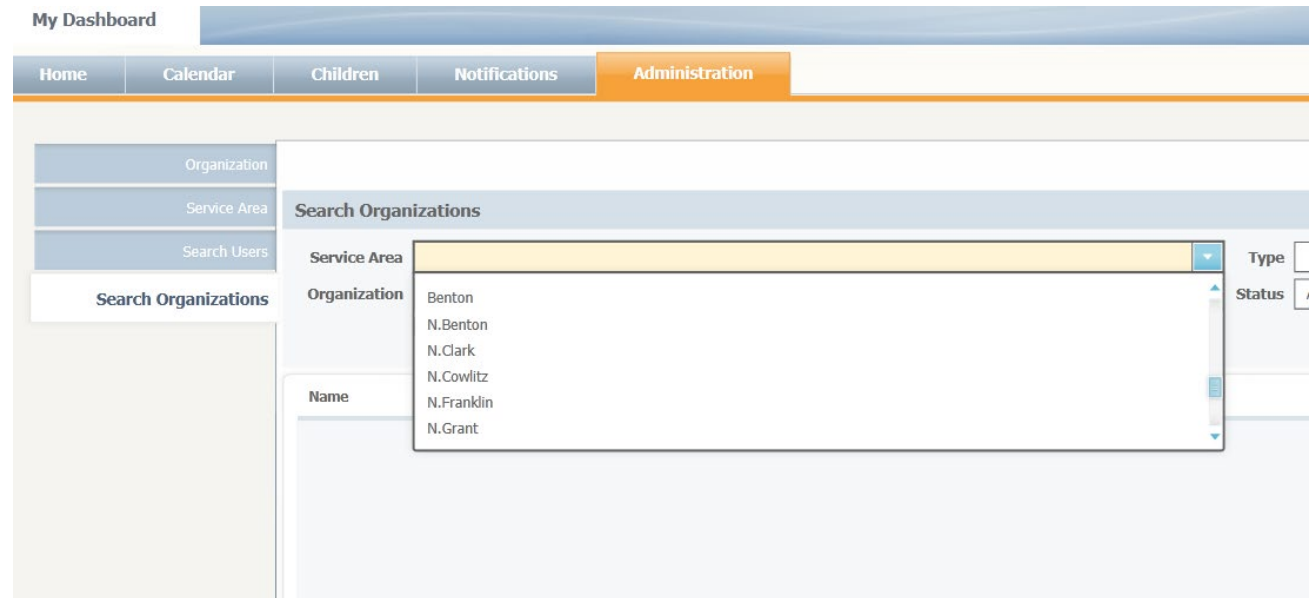

# Reports Available to School District Staff



Federal **School** Compliance FRC Provider Indicator COS Administrator Administration COS Reports

## Count Of Children in School District

This report displays a count by school district of children residing in each school district.

[View Report](#)

## School Notifications

School Districts and ESDs must be notified of children that are eligible for transition planning.

[View Report](#)

## School Notification Recipients

List of Recipients at School Districts and ESDs being notified of children that are eligible for transition planning.

[View Report](#)

# Questions?



This Photo by Unknown Author is licensed under [CC BY](#)

